

BioPro™ FlowMCP

Extension Cable



FEATURES & BENEFITS

- ✓ Extension cable to connect the BioPro™ Clamp-On SL to the BioPro™ FlowMCP
- ✓ IP Class 68 (in mated condition)
- ✓ Available in three different lengths

TECHNICAL SPECIFICATION

VARIANT	BIOPRO™ FLOWMCP EXTENSION CABLE 0.25 M	BIOPRO™ FLOWMCP EXTENSION CABLE 1.10 M	BIOPRO™ FLOWMCP EXTENSION CABLE 2.65 M*
ARTICLE NUMBER	13709	13710	13711
LENGTH	0.25 m	1.10 m	2.65 m
WEIGHT	100 g	160 g	240 g
IP CLASS	IP 68 (at round plug) in mated condition		
COMPATIBLE WITH	BioPro™ FlowMCP 1- 4 series		

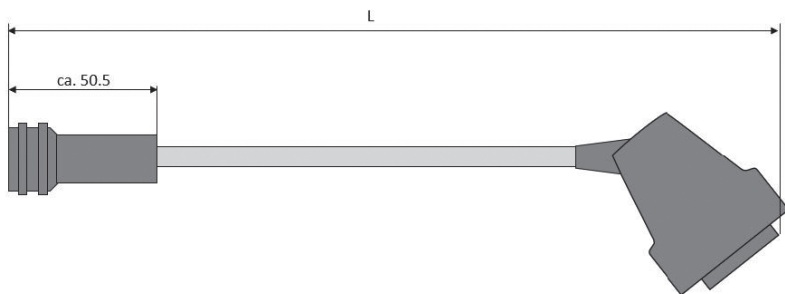

*Note: Please use a BioPro™ Clamp-On SL with a shortened sensor cable in order to stay below four meters total cable length.

USE

In order to connect the BioPro™ Clamp-On SL to the BioPro™ FlowMCP variant inside the control cabinet, a panel cut-out is needed:

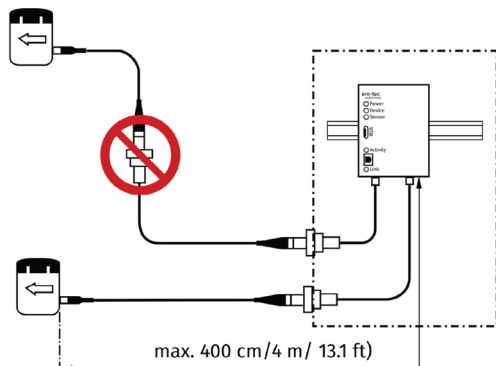

PANEL CUT-OUT

The panel cut-out must have the following dimensions:

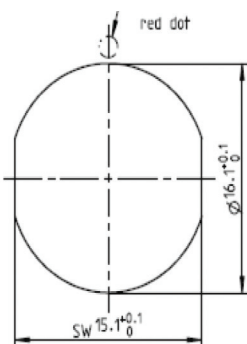

AVAILABLE ACCESSORY: PROTECTIVE CAP FOR IP 68 EXTENSION CABLE

Protective cap for IP 68 extension cable the round plug with solder plug $\varnothing 3.2$ mm

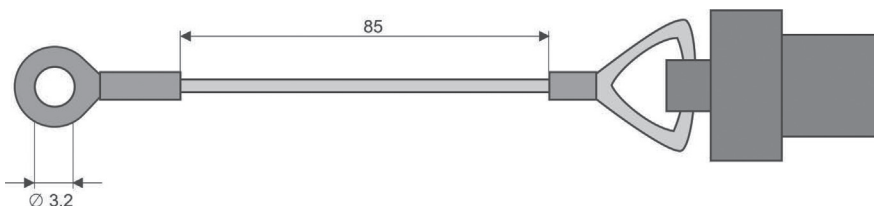

Article Number 13802
IP Class IP 68 in mated condition

DESIGN FOR LIFE